

PERMIT

CITY OF NAPOLEON - BUILDING DEPARTMENT
 255 West Riverview Avenue, Napoleon, Ohio 43545 - 419-592-4010

Permit No. 60-79 Issued 5-31-79
date

Job Location 1056 Sheffield Ave.
address

Lot 60 Highlands 2nd Add'n,
sub-div or legal discript

Issued By *R. Johnson*
building official

Owner Claris Steele
name tel.

Address 1056 Sheffield Ave.

Agent Allen Hootman 258-2169
builder-eng.-etc. tel.

Address RR 2 Antwerp, Ohio

Description of Use Detached Garage

Residential one
no. dwelling units

Commercial _____ Industrial _____

New xx Add'n. _____ Alter _____ Remodel _____

Mixed Occupancy _____

Change of Occupancy _____

Estimated Cost \$ 3,500.00

FEES	BASE	PLUS	TOTAL
<input checked="" type="checkbox"/> BUILDING	\$3.00		\$3.00
<input type="checkbox"/> ELECTRICAL			
<input type="checkbox"/> PLUMBING			
<input type="checkbox"/> MECHANICAL			
<input type="checkbox"/> DEMOLITION			
<input checked="" type="checkbox"/> ZONING	0		0
<input type="checkbox"/> SIGN			
WATER TAP			
SEWER TAP			
TEMP. ELECT.			
ADDITIONAL PLAN REVIEW	Struct. _____ hrs		
	Elect. _____ hrs		
TOTAL FEES.....			\$3.00
LESS MIN. FEES PAID _____			0
			<small>date</small>
BALANCE DUE.....			\$3.00

ZONING INFORMATION

district "A"	lot dimensions 60' x 100'	area 6000sq'	front yd n/a	side yds xxxxxxxxxx	rear yd xxxxxxxxxx
max hgt ok	no pkg spaces ok	no ldg spaces n/a	max cover ok	petition or appeal req'd variance in side & rear setbacks granted 5-17-79	
date appr					

WORK INFORMATION:

Size: Length 22' Width 16' Stories 1 Ground Floor Area 352sq'

Height _____ Building Volume (for demo. permit) _____ cu. ft.

Electrical: _____
brief description

Plumbing: _____
brief description

Mechanical: _____
brief description

Sign: _____ Dimensions _____ Sign Area _____
type

Additional Information: CALL FOR INSPECTIONS MARKED ON ATTACHED SHEET.

Date _____ Applicant Signature _____
owner-agent

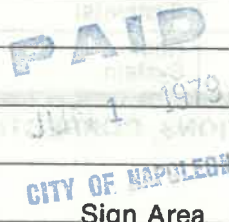

INSPECTION RECORD

UNDERGROUND			ROUGH-IN						FINAL			
PLUMBING	Type	Date	By	Type	Date	By	Type	Date	By	Type	Date	By
PLUMBING	Building Drains			Drainage, Waste & Vent Piping			Indirect Waste			Drainage, Waste & Vent Piping		
	Water Piping									Backflow Prevention		
	Building Sewer			Water Piping			Condensate Lines			Water Heater		
	Sewer Connection									FINAL APPROVAL		
MECHANICAL	Refrigerant Piping			Refrigerant Piping			Chimney(s)			Grease Exhaust System		
				Duct Furnace(s)			Fire Dampers			Air Cond. Unit(s)		
	Ducts/ Plenums			Ducts/ Plenums			<input type="checkbox"/> Radiant Htr(s) <input type="checkbox"/> Unit Htr(s)			Refrigeration Equipment		
				Duct Insulation			Pool Heater			Furnace(s)		
				Combustion Products Vents			Ventilation <input type="checkbox"/> Supply <input type="checkbox"/> Exhst.			FINAL APPROVAL		
ELECTRICAL	Conduits & or Cable			Conduits/ Cable			<input type="checkbox"/> Range <input type="checkbox"/> Dryer			Temp Service Temp Lighting		
	Grounding & or Bonding			Rough Wiring			<input type="checkbox"/> Generator(s) <input type="checkbox"/> Motors			Fixtures Lampholders		
	Floor Ducts Raceways			Service Panel Switchboard			<input type="checkbox"/> Water Htr <input type="checkbox"/> Welder			Signs		
	Service Conduit			Busways Ducts			<input type="checkbox"/> Heaters <input type="checkbox"/> Heat Cable			Electric Mtr. Clearance		
	Temporary Power Pole			Subpanels			<input type="checkbox"/> Duct Htr(s) <input type="checkbox"/> Furnace(s)			FINAL APPROVAL		
BUILDING	Location, Set-backs, Esmt(s)			Exterior Wall Construction			Roof Covering Roof Drainage			Smoke Detector		
	Excavation						Exterior Lath ¹			Demolition (sewer cap) ¹		
	Footings & Reinforcing						<input type="checkbox"/> Interior Lath <input type="checkbox"/> Wallboard					
	Floor Slab			Interior Wall Construction			Fire Wall(s)			Building or Structure		
	Foundation Walls			Columns & Supports			Fireplace Chimney					
	Sub-soil Drain			Crawl Space <input type="checkbox"/> Vent <input type="checkbox"/> Access			Attic <input type="checkbox"/> Vent <input type="checkbox"/> Access					
	Piles			Floor System(s)						FINAL APPROVAL BLDG. DEPT.		
			Roof System			Special Insp Reports Rec'd			Certificate of Occupancy Issued			
ADDITIONAL	INSPECTIONS, CORRECTIONS, ETC.						INSPECTIONS, CORRECTIONS, ETC.					

10/18/29 [Signature]

R.S.J.

CITY OF HAVESON
BUILDING INSPECTION DEPARTMENT
APPLICATION FOR BUILDING PERMIT
(please print or type)

The undersigned hereby makes application for construction, installation, or alteration work as herein specified, agreeing to do all such work in strict accordance with the City of Haveson's adopted Building Codes.

Owner's Name Claris Steele Address 1056 Sheffield

Contractor Allen D. Hootman Telephone No. 258-2169

Address R 2 - Antwerp, Ohio

Location of project 1056 Sheffield Cost of project 3500.00

Lot Information: (not required for siding job)

Lot No. 60 Subdivision 2nd Highland Addl.

Zoning District _____ Lot Size 60 ft. x 100 ft. Area 6000 sq. ft.

Setbacks: Front _____ Right Side _____ Left Side _____ Rear _____

Building Information:

Residential 1 Commercial _____ Industrial _____
No. Units

Addition _____ New Construction Remodel _____

Accessory Building GARAGE Siding ALUMINUM
Specific Type

Brief Description of Work: _____

Size: Length 22 width 16 No. of Stories _____

Area: 1st Floor 352 sq. ft. Basement _____ sq. ft.

2nd Floor _____ sq. ft. Accessory Building _____ sq. ft.

3rd Floor _____ sq. ft. Other _____ sq. ft.

Additional Information: _____

APPLICATION FOR PERMIT SHALL BE ACCOMPANIED BY TWO COMPLETE SETS OF PLANS INCLUDING: ELEVATIONS, FLOOR PLANS, CROSS SECTIONS AND PLOT PLAN. IF ADDITION OR REMODELING, SHOW ALL EXISTING STRUCTURES AND THEIR SIZE AND LOCATION. ALL PLANS SHALL BE DRAWN TO SCALE.

Date 30 May 79 Applicant's Signature Allen D. Hootman

60 79

3.08

Als Garage & Door

AL HOOTMAN
PHONE 899-2221

Box 206
Sherwood, Ohio 43556

PROPOSAL

PROPOSAL SUBMITTED TO CLARIS STEELE		PHONE 592-1219	DATE 23 May 79
STREET 1056 N. Sheffield		JOB NAME	
CITY, STATE AND ZIP CODE Napoleon, Ohio		JOB LOCATION	
ARCHITECT	DATE OF PLANS	JOB PHONE	

WE HEREBY SUBMIT SPECIFICATIONS AND ESTIMATES FOR: **16'X 22' Garage**

1. **6"x 24" footer**
2. **4" floor (reinforced)**
3. **2" min stone fill**
4. **2x4 studs 16" o.c.**
5. **2x6 ceiling joists 24" o.c.**
6. **2x6 rafters 24" o.c.**
7. **1x4x8 sidewall sheathing**
8. **1x4x8 roof sheathing (plywood)**
9. **3 in 1 self sealing roofing**
10. **16" overhang, 12" on ends**
11. **All aluminum exterior**
12. **2 - 20/16 windows**
13. **1 - 2'8" walk in door**
14. **1 - 9x7 overhead door**

WE PROPOSE HEREBY TO FURNISH MATERIAL AND LABOR - COMPLETE IN ACCORDANCE WITH ABOVE SPECIFICATIONS, FOR THE SUM OF:

Three thousand five hundred twenty _____ dollars (**\$3520.00**).

PAYMENT TO BE MADE AS FOLLOWS:
\$1500.00 at the onset, balance on completion

All material is guaranteed to be as specified. All work to be completed in a workmanlike manner according to standard practices. Any alteration or deviation from above specifications involving extra costs will be executed only upon written orders, and will become an extra charge over and above the estimate. All agreements contingent upon strikes, accidents or delays beyond our control. Owner to carry fire, tornado and other necessary insurance. Our workers are fully covered by Workmen's Compensation insurance.

Authorized Signature *Allen D. Hootman*
Note: This proposal may be withdrawn by us if not accepted within 30 days.

ACCEPTANCE OF PROPOSAL - The above prices, specifications and conditions are satisfactory and are hereby accepted. You are authorized to do the work as specified. Payment will be made as outlined above.

Signature _____

Date of Acceptance: _____

Signature _____

ALLEY

100 ALLEY



ELECTRIC SERVICE

Water Line

Side Walk

OLD GARAGE
NEW GARAGE

EXISTING DRIVE

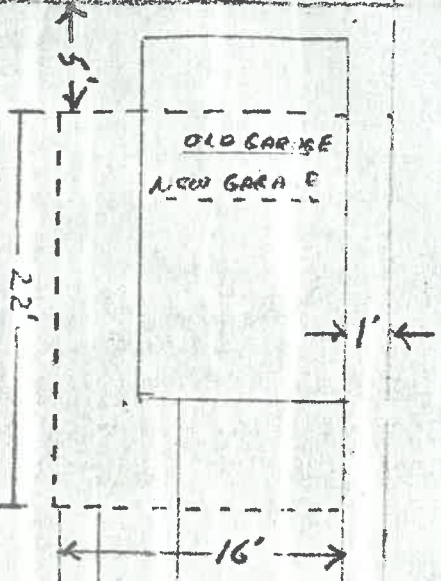

60'



